



Welcome to Mitaka Open House Day 2018 !

This annual open house showcases 4 institutes: the National Astronomical Observatory of Japan; the Astrobiology Center; the Institute of Astronomy, University of Tokyo; and the Department of Astronomical Science, School of Physical Sciences, the Graduate University for Advanced Studies (SOKENDAI).

There are many fun events, such as, public viewing of the research facilities, exhibitions, lectures, and so on. Stargazing parties will be held at the Sports Field, and exhibitors will offer goods for sale. In addition, the Mitaka Picture Book House in the Astronomical Observatory Forest will offer exhibitions. Let's enjoy the Mitaka Open House at the Mitaka Campus surrounded by nature.

Oct. 27, 2018

Detailed
Event Information

This is available at the information corner in the rotary.

S3 Resting Room (10 a.m. - 5 p.m.)

C2 Resting Space (10 a.m. - 7 p.m.)

Where can I relax?

Also please feel free to use the outdoor benches.

Injury and Illness

C2 Healthcare Room (There is a nurse.)



naoj_mtk

https://instagram.com/naoj_mtk/

Twitter

@naoj_mtk

https://twitter.com/naoj_mtk

To participate in Mitaka Open House Day 2018, please post photos to SNS.
(Please use the hashtag #naojday)

When you post to SNS, please show it to one of the event staff who have the hashtag written on their backs. They will present you with a souvenir!

This event staff
wear light blue coats.

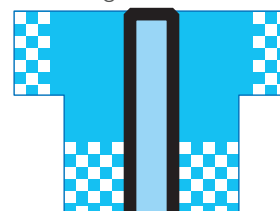

Mitaka Open House Day 2018 Web site

<https://www.nao.ac.jp/en/open-day/2018/>

STAFF

Languages Spoken

Staff members who can speak languages other than English wear stickers.

All staff members will make an effort to speak English.



English OK!

Events that can be enjoyed entirely in English display this sign.

Stargazing Parties **Weather Permitting.**



Solar observations (Using a Solar projection board)

10 a.m. - 3 p.m. **S1** 20-cm Telescope Dome



Solar observations (Using the Solar Radio Telescope)

10 a.m. - Noon
1 p.m. - 3 p.m. **SR** Solar Radio Telescope



Stargazing (Using the 50-cm Telescope)

N2 50-cm Telescope for Public Outreach

1 p.m. - 4 p.m. **Anyone can Stargaze.**

(4 p.m. - 5 p.m. Stargazing pauses)

5 p.m. - 7 p.m. **Tickets are required.**

Tickets will be distributed starting from 4:50 p.m.
(Venue: In front of the 50-cm Telescope dome)
In the case of rain or clouds, tickets may not be handed out.



Stargazing (Sports Field)

Stargazing and Equipment Exhibition by manufacturers and dealers.

1 p.m. - 7 p.m. **Anyone can Stargaze.**

Special Event "Uni-Tama"

The Universe + Ball (Tama) = Uni-Tama! We project the dynamic Universe on a huge balloon!

10:30 a.m. - 11:30 a.m.



Subaru Building Large Seminar Room

We use a balloon with a diameter of 2 meters.

5:30 p.m. - 6:30 p.m. Uni-Tama open air



Sports Field **Weather Permitting.**

We use a balloon with a diameter of 4 meters!



Smoking is strictly prohibited except in the Smoking Area.
Service dogs are allowed.

Until 4 p.m. Events are today only.
(Some events close at 3 p.m.)

Until 5 p.m. Events are today only.

Until 5 p.m. You can visit every day,
but there are special events today only.

Until 5 p.m. You can visit every day.
Self guided.

Until 7 p.m. Events are today only.

NAOJ Audio Guide



Please use the audio guide
when you visit.
Please scan the 2D bar code
with your smartphone
or tablet to access the website.

<https://www.nao.ac.jp/study/mitaka-guide/>

Solar Flare Telescope
Weather Permitting.

If this event is cancelled,
the stamp will be moved to
the reception desk.

Rest Area (outdoor) Rest Area (indoor)

Lavatory

AED Healthcare Room

Nursing Space Public Telephone

Smoking Area Vending Machine

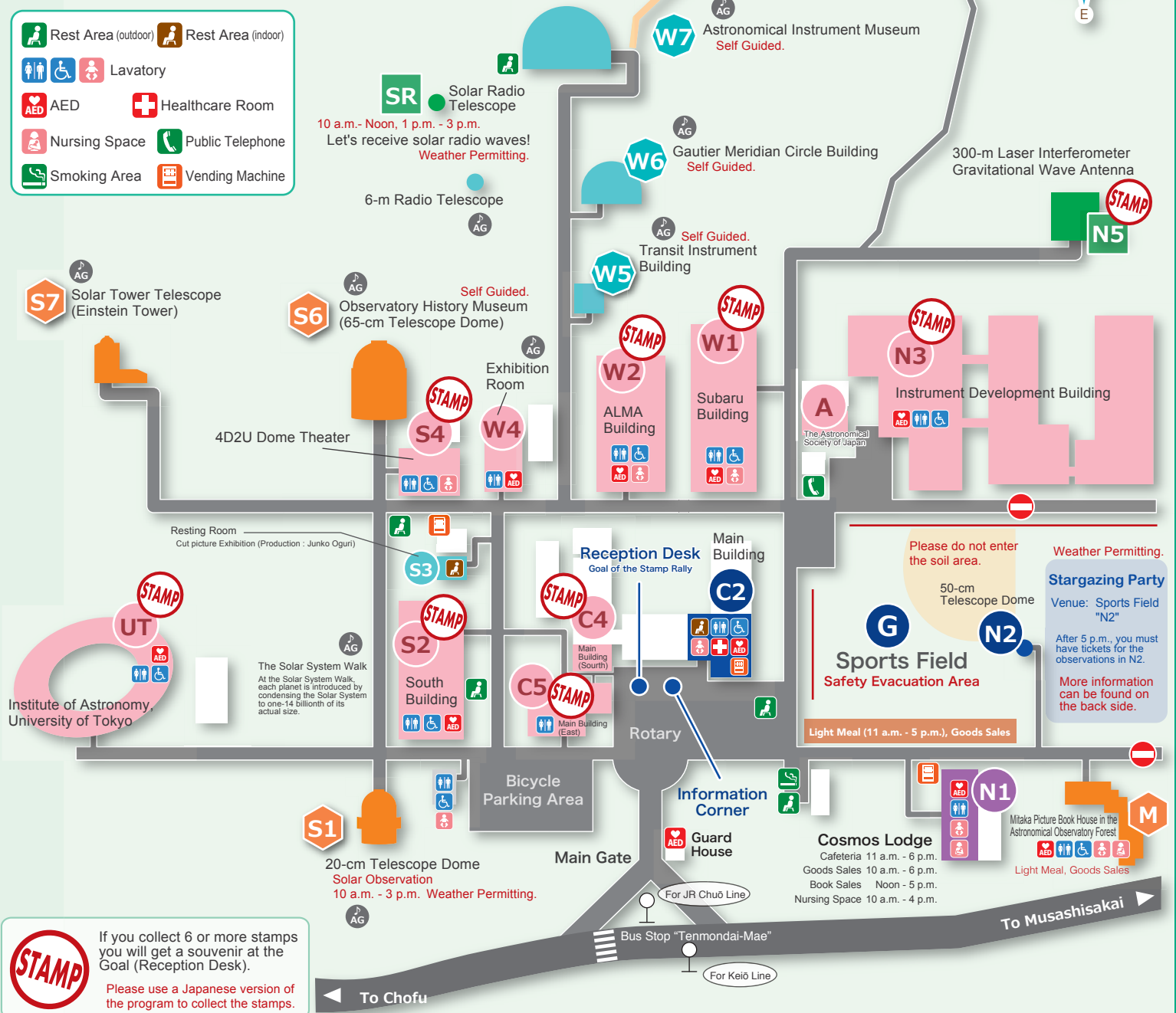

If you collect 6 or more stamps
you will get a souvenir at the
Goal (Reception Desk).

Please use a Japanese version of
the program to collect the stamps.

C2 Main Building

10 a.m. - 7 p.m. (All of the events will end at 7 p.m. Please allow time to look around.)

1 JASMINE Project Office

Introduction to Japan Astronomy Satellite Mission for Infrared
Exploration (JASMINE).

Exhibition **Demonstration, Experiment**

2 11 a.m. - 7 p.m. Let's Ask a Researcher!

Let's ask the National Astronomical Observatory of Japan,
the Astrobiology Center and the University of Tokyo researchers!

3 Solar Science Observatory "Space" Venue

Introduction to the Solar Science Observatory.

VR Stereoscopic VR Device

Limited to age 7 years and older. And parental consent is
required under 13 years old.

Monoscopic VR Device

No age limit. Anyone can enjoy.

Exhibition **Demonstration, VR Experience**

Short Lecture

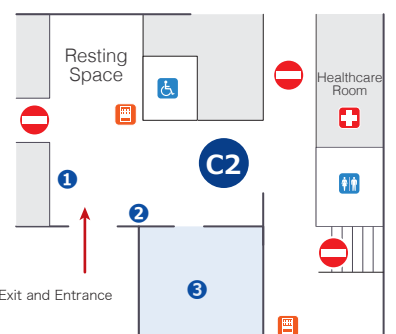

W9 Solar Flare Telescope 10 a.m. - 4 p.m. (Last entry 3:30 p.m.)

STAMP Solar Science Observatory "Earth" Venue

Introduction to the Solar Science Observatory.

You can visit solar observation facilities such as the Solar Flare Telescope.

Weather Permitting.

Exhibition, Open Facilities, **Short Lecture**

N3 Instrument Development Building 10 a.m. - 5 p.m. (Last entry 4:30 p.m.)

STAMP Advanced Technology Center

Open facility to develop and produce astronomy observation equipment.
There are exhibits on the latest projects.

Open Facilities, Demonstration, Exhibition, Experiment

W1 Subaru Building 10 a.m. - 5 p.m. (Last entry 4:30 p.m.)

STAMP ① Subaru Telescope ② TMT-J Project Office ③ Division of Optical and Infrared Astronomy

Introduction to Subaru Telescope and TMT(Thirty Meter Telescope).

Let's make a spectrometer and observe the light!

Science Cafe, Exhibition

Card Game

Handicraft, Experiment

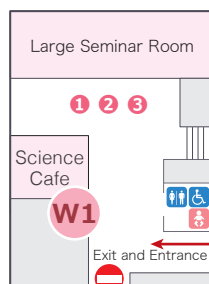

S2 South Building 10 a.m. - 5 p.m. (Last entry 4:30 p.m.)

STAMP ① Astronomy Data Center

Let's search for galaxies in Subaru telescope /Hyper Suprime-Cam (HSC) image panels.

Game, Exhibition

② Center for Computational Astrophysics

You can visit up close with a computer cluster active in simulation astronomy.

Entrance Tickets are required.

Open Facilities, Exhibition

③ Library

Let's read astronomy books!

Open Facilities, Exhibition

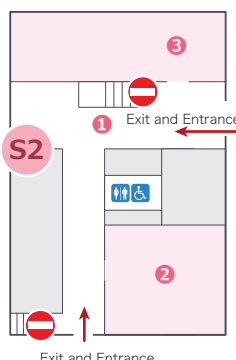

C4 C5 Main Building (S),(E) 10 a.m. - 5 p.m. (Last entry 4:30 p.m.)

STAMP ① Mizusawa VLBI Observatory, RISE Project

Introduction to Very Long Baseline Interferometry (VLBI), Event Horizon Telescope (EHT), Research of Interior Structure and Evolution of solar system bodies.(RISE)

Exhibition **Experiment, Demonstration**

STAMP ② Astrobiology Center

Introduction to the Astrobiology Center.

Exhibition **Mystery**

③ Nobeyama Radio Observatory

The Nobeyama 45-m Radio Telescope was certified as an IEEE (The Institute of Electrical and Electronics Engineers) milestone.

Exhibition **VR Experience**

Parabolic antenna experiment with Super Balls

VR Limited to age 7 years and older. Parental consent required for guests under 13 years old.

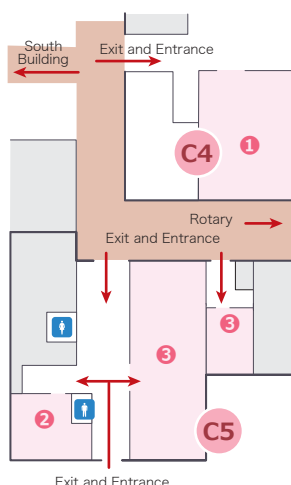

N5 300-m Laser Interferometer Gravitational Wave Antenna 10 a.m. - 4 p.m. (Last entry 3:30 p.m.)

STAMP Gravitational Wave Project Office

Introduction to laser interferometer gravitational wave antennas "KAGRA" and "TAMA300."

You can visit "TAMA300" in the basement.

Open Facilities, Exhibition

A The Astronomical Society of Japan 10 a.m. - 5 p.m.

Introduction to the Astronomical Society of Japan.

Exhibition, Book Sales

W2 ALMA Building 10 a.m. - 5 p.m. (Last entry 4:30 p.m.)

STAMP NAOJ Chile Observatory

Introduction to the Atacama Large Millimeter/submillimeter Array (ALMA).

5000-m altitude ALMA site VR experience.

Let's receive radio waves with a wok! (**Weather Permitting.**)

Exhibition, Short Lecture, **VR Experience** **Experiment, Demonstration**

VR Limited to age 7 years and older. Parental consent required for guests under 13 years old.

W4 Exhibition Room 10 a.m. - 5 p.m. (Last entry 4:30 p.m.)

① TMT-J Project Office

Exhibition of TMT (Thirty Meter Telescope) model and mirror material.

Open Facilities, Exhibition

Let's complete the TMT primary mirror

② Public Relations Center

Astronomy for Everyone

Let's connect with the world through astronomy activities.

Exhibition **Quiz**

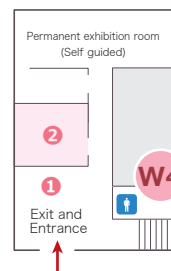

S4 4D2U Dome Theater 10 a.m. - 5 p.m. (Last entry 4:30 p.m.)

STAMP Division of Theoretical Astronomy, 4D2U Project

Researchers will lecture while you watch a 4-dimensional image of the Universe that has been created by supercomputer calculations.

Lecture requires tickets. Limited to elementary school students and older.

Open Facilities, Exhibition **Short Lecture**

UT Institute of Astronomy, University of Tokyo 10 a.m. - 5 p.m. (Last entry 4:30 p.m.)

STAMP Welcome to the University of Tokyo !

We are tackling various mysteries in astronomy at the Kiso Observatory, TAO, and ASTE.

Open Facilities, Exhibition, Demonstration
Short Lecture, VR Experience, Quiz

S6 Observatory History Museum 10 a.m. - 5 p.m. (Last entry 4:30 p.m.)

Exhibition of authentic Historical Books

Exhibition of real Historical Books today only !
Theme: "The Solar System"

Exhibition

M Mitaka Picture Book House in the Astronomical Observatory Forest 10 a.m. - 5 p.m.

Autumn Festival 2018

Woodworking, Goods sale etc..A lot of fun event sare planned !
(Autumn Festival is 11 a.m. - 4 p.m.)

Open Facilities, Exhibition, Goods Sales

Picture-story show, Handicraft

Restrictions. **Children can enjoy.** **Tickets are required.**